

FEATURED PRODUCTS FROM TP ORTHODONTICS

# Innovations in Orthodontics

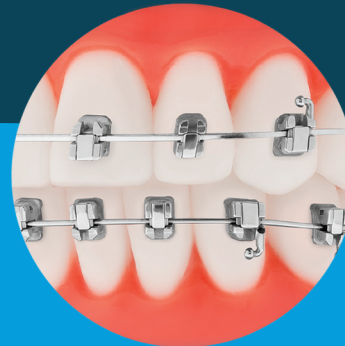
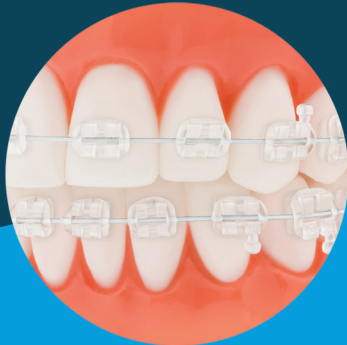

TP Orthodontics, Inc.  
tportho.com

Trusted  
innovative  
products  
and  
solutions.



Note: All TPO products may not be available in your area.  
Contact your TPO representative for more information.



# ORTHODONTIC INNOVATION Starts Here

TP Orthodontics offers some of the most innovative products and solutions available. Choose TPO for the latest in aesthetic orthodontic treatment including brackets featuring *Personalized Color-Matching Technology*®, and finishing solutions to meet the needs of any practice – including the original Tooth Positioner that inspired aligner treatment as we know it today.

## Trust That's Been Earned.

When you choose TP Orthodontics, you can be assured the products used in your practice are designed for efficiency, dependability and overall patient satisfaction. That's how we built our reputation as one of the most trusted suppliers of quality orthodontic products and solutions – and the reason we've been at this since 1942.

## Unmatched Quality Standards.

TPO® maintains a worldwide Quality Management System that adheres to international standards and governmental regulations required for medical devices. This means you can be confident the products you receive from TP Orthodontics are held to the most rigorous standards in the industry – not every supplier can say that!

As the most experienced manufacturer in the industry, TP Orthodontics is a name you can trust.

# AESTHETIC BRACKETS

The clear match for you AND your patients.

TPO provides you and your patients the ultimate combination of beauty and performance with our extensive line of aesthetic bracket systems.

## ClearVu® and InVu® Cosmetic Brackets

The doctor-preferred design coupled with patient preferred aesthetics.

- TPO's unique flexible polymer mesh base serves as a protective barrier between the ceramic bracket and enamel<sup>1</sup>
- No special tools are required for debonding and no need to fracture the bracket
- True-twin design for multiple, secure ligation options
- Available delivered in an indirect bonding tray, a custom solution for enhanced efficiency and bonding precision. Find out more or submit a case at [tportho.com/custom](http://tportho.com/custom)

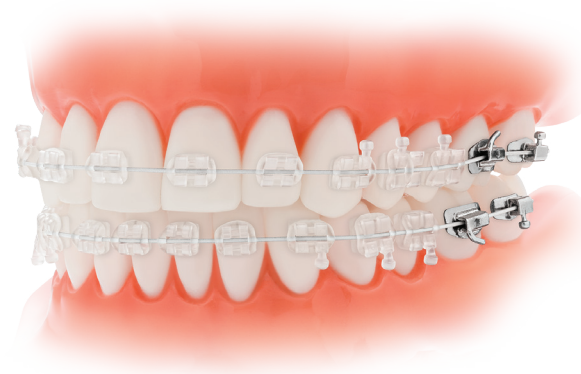

## Personalized Color-Matching Technology®

- Proprietary ceramic material closely duplicates optical properties of natural teeth
- Absorbs certain wavelengths of light, allowing only natural tooth color to show
- Creates a look of transparency that matches virtually any tooth color
- Brackets are stain-resistant and will not discolor



Virtually Invisible

Flexible Polymer Base

Enamel Protection

Pre-Coated

Easy Debonding

Multiple Ligation Options



## Pre-Coated Aesthetic Brackets featuring eXact® Pre-Applied Adhesive

- Pre-coated for convenient placement right out of the package
- Reduced risk of contamination
- Brackets set easily without sliding
- Minimal flash clean-up



## Aesthetic Archwire



- Perfect for use with ceramic brackets
- Features a thin tooth-colored coating on the labial surface that does not alter the wire size or function
- Uncoated near the archwire slot to glide smoothly with no increase in friction
- Available in a variety of arch shapes and wire types
- Exclusive Convenience-Pak® hygienic packaging

### Meet Patient Demand and Set Your Practice Apart

More patients than ever are requesting aligner treatment. *Personalized Color-Matching Technology* brand brackets from TPO are an excellent solution for patients who are not suitable candidates for aligner therapy. Use TPO ceramic brackets to start and keep your aesthetic cases on track – with predictable results. This unique solution is available with the following TPO bracket lines:

- ClearVu Cosmetic Brackets
- InVu Aesthetic Brackets
- Tip-Edge PLUS Aesthetic Brackets

# Nu-Edge® COBALT CHROMIUM BRACKETS

Superior strength meets biocompatibility.

Look to TPO's Nu-Edge portfolio for nickel-free treatment options.

## Nu-Edge Self-Ligating Brackets

The proven CoCr performance of Nu-Edge brackets with a self-ligating design.

- Cobalt chromium is biocompatible for nickel-sensitive patients
- Robust sliding archwire gate
- No special tools required
- Multiple ligation options

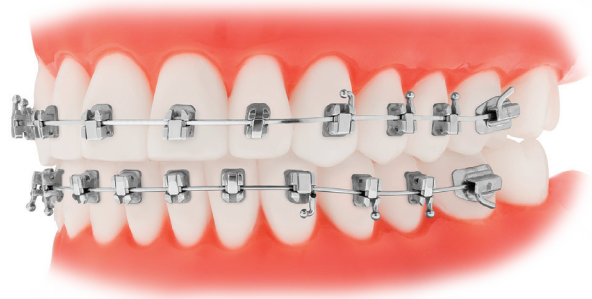

## Nu-Edge Twin Brackets

Stronger CoCr alloy material. Lower friction.  
Superior compatibility.

- Biocompatible for nickel-sensitive patients
- Cobalt chromium for added strength and reduced friction compared to stainless steel<sup>2</sup>
- Available with a vertical slot for versatility
- Dependable twin design



Biocompatible  
Low-Friction  
Cobalt Chromium  
Simplified Debonding  
Multiple Ligation Options

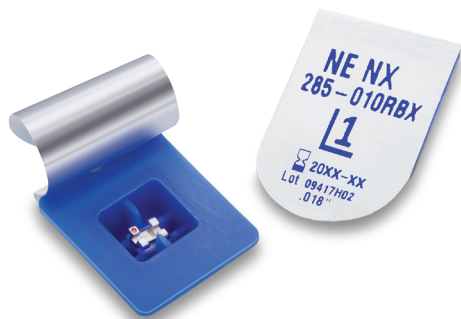

## Nu-Edge NX® Cobalt Chromium Pre-Coated Brackets

Convenient placement, reduced chairtime.

- Ready to place right out of the package for increased efficiency
- Pre-coated with eXact orthodontic adhesive for easy clean-up
- A low profile mini-twin design for patient comfort
- Biocompatible for sensitive patients
- Exceptionally strong CoCr helps to prevent archwire slot collapse

# AUXILIARIES

## Coated Crimpable Hooks



- Can accept force loads equal to welded or soldered hooks on round and rectangular wires
- Inner surface features an abrasive coating for enhanced gripping force
- Available in oriented packaging for ease of use
- Aesthetic available

Crimpable hook pliers or power crimping pliers are recommended for application.

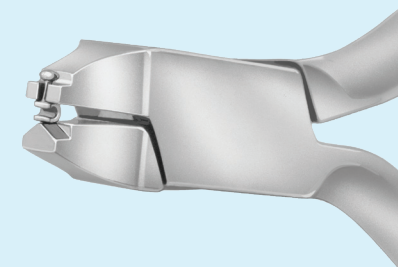

## Ultra Low Profile Molar Tubes



- Extremely low profile for greater patient comfort
- Minimizes potential for occlusal force interference
- Funnel-shaped entrance for ease of wire insertion
- Anatomically contoured base and indent guides for easy, accurate positioning

# Tip-Edge<sup>®</sup> PLUS BRACKETS

Designed for treatment efficiency and patient comfort.

Tip-Edge PLUS brackets are part of a versatile system that utilizes light forces to move teeth naturally and efficiently. Archwire binding is eliminated due to the unique slot design, reducing a major source of friction. Results are seen quickly and the doctor can schedule patient appointments less frequently – potentially reducing overall treatment times compared to twin brackets.

- Efficient treatment without the need for headgear, implants or functional appliances
- Pre-adjusted to capture 100% torque and tip – zero-tolerance finish
- Extremely light forces – only 1 to 3 ounces
- Automatic rotational control
- Eliminates unwanted torque reaction to adjacent teeth
- *Personalized Color-Matching Technology* brand ceramic option available for enhanced aesthetics



Tip-Edge PLUS is available in ceramic, metal, combination and pre-coated options.

## PLUS SL<sup>®</sup> Brackets

The next generation in Tip-Edge Technology. The results you expect with the added benefits of passive self-ligation.

- Available delivered in an indirect bonding tray, a custom solution for enhanced efficiency and bonding precision

Find out more or submit a case at [tportho.com/custom](http://tportho.com/custom)



Light Forces  
Less Chair Time  
Metal or Ceramic Options  
Versatile Treatment Options



# ORTHODONTIC ADHESIVE

A reliable, secure bond for your patients.

TPO offers a comprehensive line of orthodontic adhesive options for optimal convenience.



## eXact Clear Orthodontic Adhesive

- Excellent tack properties prevent bracket sliding
- Cures clear
- Provides optimal bond strength
- For use on metal or ceramic brackets

## CrossLink® Light Cure Band Cement

- No sealant required
- Complete cure in 30 seconds
- Excellent band retention
- Blue for visibility when cleaning excess flash



## Readi-Base®, featuring eXact Pre-Applied Adhesive

- Pre-coated for convenient placement right out of the package
- Reduced risk of contamination
- Brackets set easily without sliding
- Minimal flash clean-up
- Available on metal and aesthetic brackets

# Flip-Lock® HERBST® APPLIANCE

The innovative Flip-Lock HERBST revolutionizes the traditional HERBST appliance.

Your best choice for correcting Class II malocclusions, this unique fixed appliance allows a significantly wider range of mandibular movement than typical HERBST designs.

- Activates using the "Flip-Lock" mechanism
- Place crimpable spacers at regular intervals onto the exposed piston
- No pins or screws
- Available with and without a cantilever arm
- Optional archwire slots allow the appliance to be placed in conjunction with brackets



**Both the piston and sliding tube easily lock by hand onto the ball-joints — no special instruments needed.**

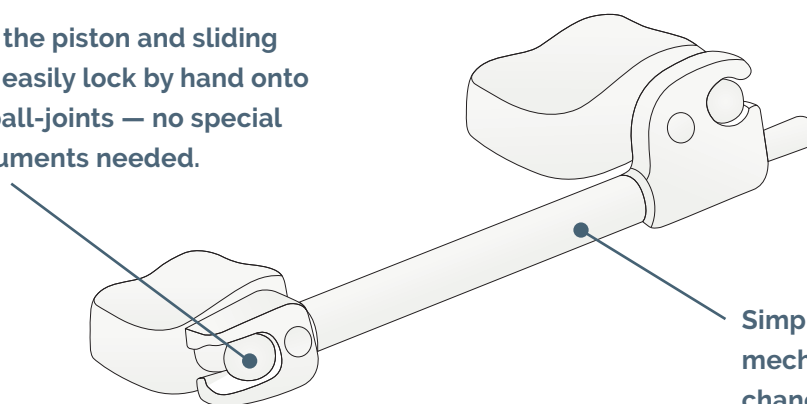

**Simple tube/piston mechanism eliminate any chance of locking into open bite position.**

## Easy Assembly

Reduced Breakage

One-Piece Cantilever and Ball  
Activates in Seconds

Lateral Mandibular Movement

# Pre-Finisher® SEMI-CUSTOM FINISHING APPLIANCE

Off-the-shelf convenience, semi-custom finishing solution.

The Pre-Finisher appliance is a semi-custom solution perfect for improving the occlusion in aligner and fixed-appliance patients. When used as an adjunct to aligner treatment, it can reduce or eliminate additional trays required for case refinement – while correcting the posterior open bite often seen with aligner patients.

- No laboratory wait or fees; immediate delivery to the patient
- Relates teeth in both arches simultaneously; corrects open bite
- Aligns, rotates and closes spaces
- Sized in one-millimeter increments for precise fitting
- Optional seating springs facilitate placement and retention
- Ideal solution for the already-compliant aligner patient
- Results in 2-3 weeks

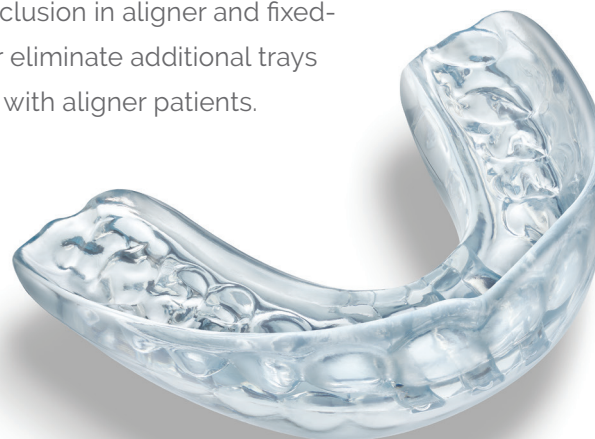

Semi-Custom Solution  
Ideal for Aligner Cases  
Easy Measurement  
Immediate Delivery  
Unique Molded Airways

TP Orthodontics, Inc.  
100 Center Plaza  
La Porte, IN 46350-9672 USA  
800.348.8856

 [tportho.com](http://tportho.com)

 [facebook.com/tportho](https://facebook.com/tportho)

 [youtube.com/user/tportho](https://youtube.com/user/tportho)

 [linkedin.com/company/tp-orthodontics](https://linkedin.com/company/tp-orthodontics)

Visit **tportho.com**  
or contact one of our offices  
below to learn more:

#### WORLDWIDE HEADQUARTERS

**United States**  
100 Center Plaza  
La Porte, Indiana 46350-9672 USA  
800-348-8856  
[info@tportho.com](mailto:info@tportho.com)

#### RESELLERS

A list of authorized resellers  
can be found on our website at:  
[tportho.com/about/distributors](http://tportho.com/about/distributors)

#### INTERNATIONAL OFFICES

**Australia**  
Tel: 61 +3 9342 3200  
Toll-free: 1 800 643 055  
[tpaus@tportho.com](mailto:tpaus@tportho.com)

**China**  
Tel: +86-510-8516 3367  
[tpchina@tportho.com](mailto:tpchina@tportho.com)

**England / Europe**  
Tel: 44 (0) 113 220 3238  
[tpeng@tportho.com](mailto:tpeng@tportho.com)

Belgium: +32 50 89 64 11  
France: +33 2 59 60 30 53  
Netherlands: +31 20 259 2003  
Portugal: +351 21 124 6897  
Spain: +34 936 41 54 81

**Japan**  
Tel: 81 3 5961 3800  
[tpoj@tportho.com](mailto:tpoj@tportho.com)

**México / Latin America**  
Tel: (55) 5662 56 67  
Toll-free: 01 800 711 8035  
[tpmex@tportho.com](mailto:tpmex@tportho.com)

**South Africa**  
Tel: +27 (0) 11 100 0956  
[tporthosa@tportho.com](mailto:tporthosa@tportho.com)



100-014ENGK, Rev. 4 - 4/25

1. Clinical performance of uncoated and precoated polymer mesh base ceramic brackets; Hüdanur Yilmaz (née Huda Abulkbash) and Selma Elekdag-Türk; Progress in Orthodontics (2019) 20:4.
2. Data on file.
3. Efficacy of the mini tooth positioner in improving orthodontic finishes; Peyton D. Cometti, Jeryl D. English, and F. Kurtis Kasper; AJO-DO (2019) 155:6.

Patents apply. See [tportho.com/patents](http://tportho.com/patents) for current list.

© 2025 TP Orthodontics, Inc. All rights reserved.

